

Sligo Creek Trail

Length: 10.6 miles of hard surface trails

Updated: Aug. 2002

1 of 3

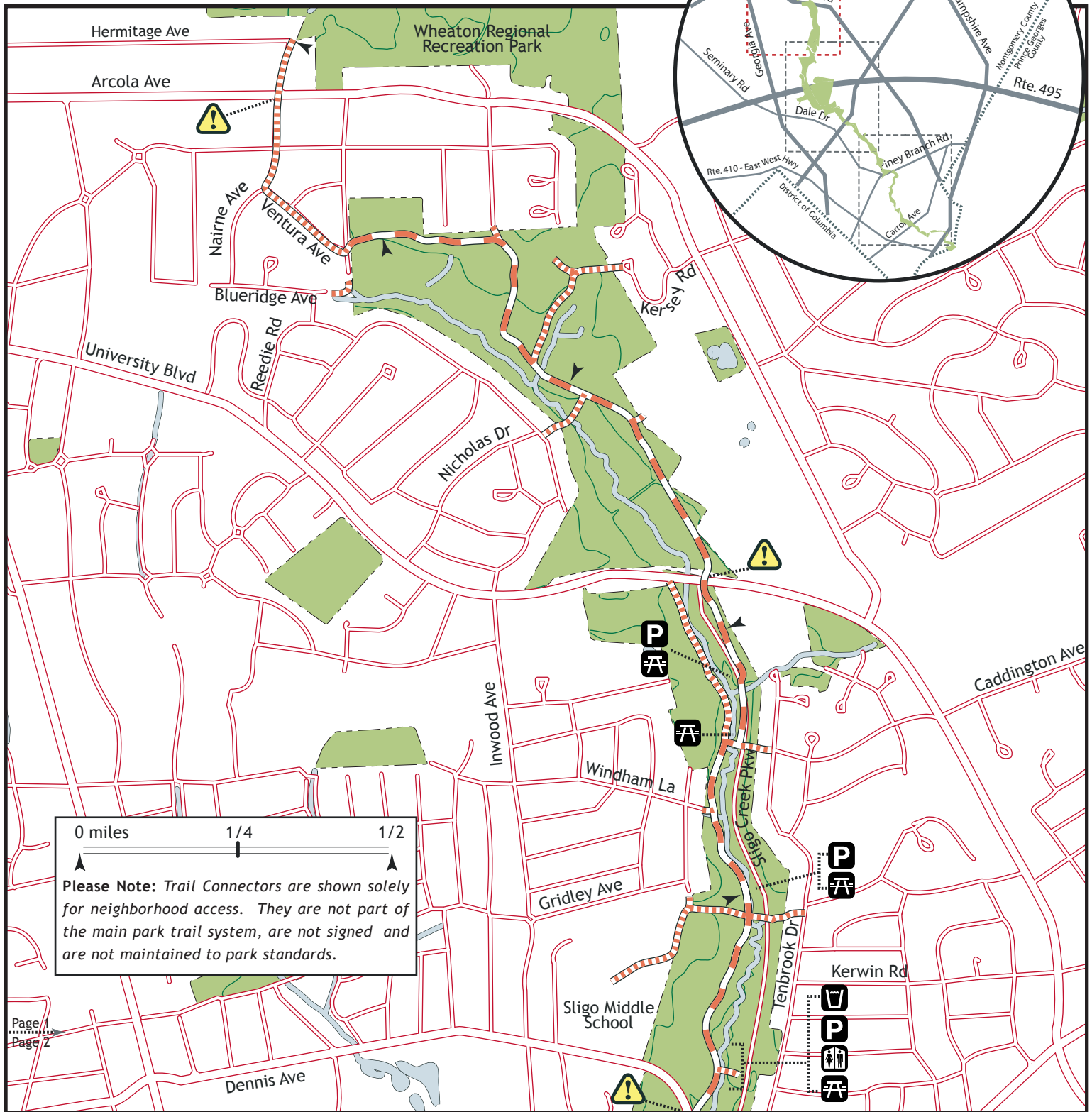

Trail Features

From the top the Sligo Creek Trail connects to the southern edge of Wheaton Regional Park at Nairne and Ventura Aves. It then follows the Sligo Creek stream valley. At University Blvd. in Wheaton it begins to follow Sligo Creek Pkwy. weaving down the parkway all the way to New Hampshire Ave. in Takoma Park.

- Hard Surface Trail
- Trail Connector
- Natural Surface Trail
- Trail Connector
- Hiker Only Trail
- Trail Connector
- Parklands & Topography
- Streams & Rivers

- Use extreme caution crossing road
 - Steep Slope
 - Drinking Water
 - Parking
 - Bathrooms
 - Picnic Area
- Park Police:** 301.949.3010 (Emergency Only)
Park Manager: 301.650.2600

Sligo Creek Trail

Page 1
Page 2

Page 2
Page 3

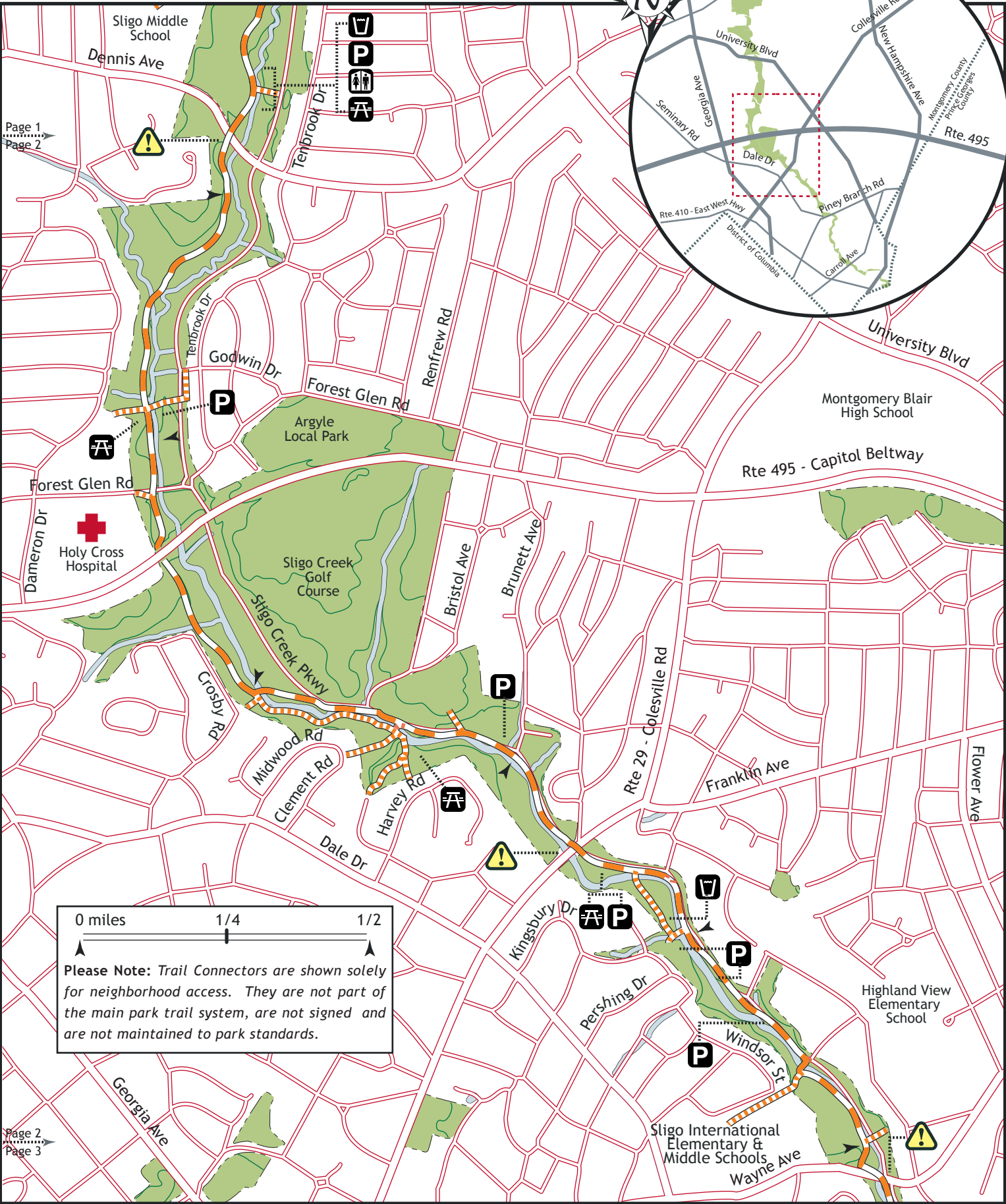

Park Police: 301.949.3010
(Emergency Only)
Park Manager: 301.650.2600

Sligo Creek Trail

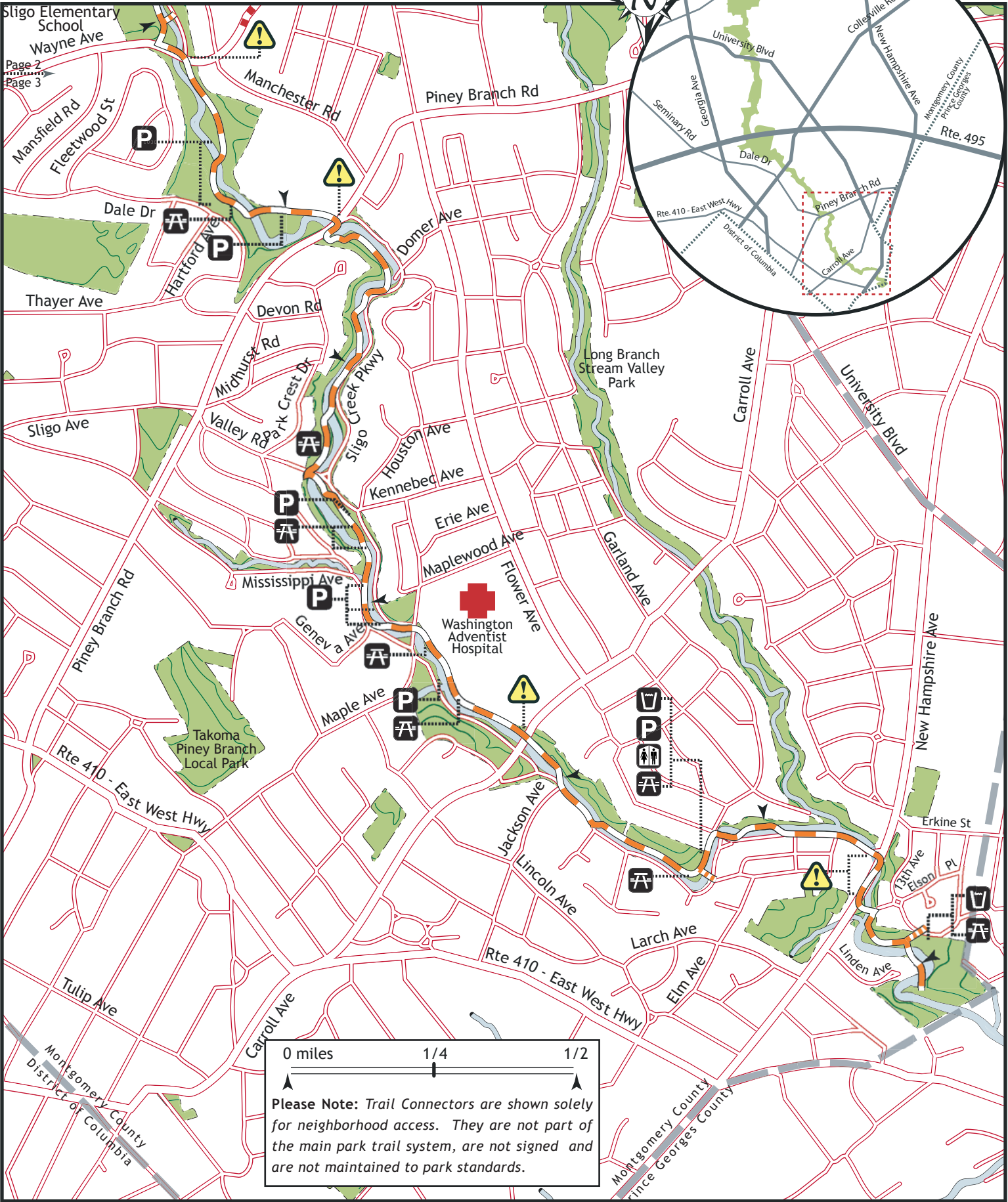

0 miles 1/4 1/2

Please Note: Trail Connectors are shown solely for neighborhood access. They are not part of the main park trail system, are not signed and are not maintained to park standards.



Park Police: 301.949.3010
(Emergency Only)
Park Manager: 301.650.2600